

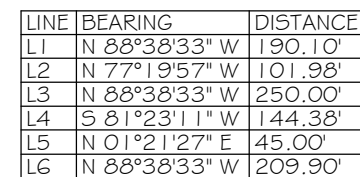

A TRACT BEING PART OF THE NORTHWEST AND NORTHEAST QUARTERS OF  
SECTION 19, TOWNSHIP 1 SOUTH, RANGE 8 WEST OF THE  
FOURTH PRINCIPAL MERIDIAN, ADAMS COUNTY, ILLINOIS



NORMAN D. ELLERBROCK  
ILLINOIS PROFESSIONAL LAND SURVEYOR #35-3159  
LICENSE EXPIRES NOVEMBER 30, 2024  
ILLINOIS PROFESSIONAL DESIGN FIRM #184-006044

1" = 200'  
GRAPHIC SCALE



A horizontal scale bar with tick marks at 0, 100, 200, and 400. The bar is divided into four equal segments, each representing 100 feet.

5) THE FIELD WORK WAS COMPLETED JULY 2023

PRELIMINARY

PLAT OF SURVEY  
SEC. 19, T1S, R8W  
4TH PM, ADAMS COUNTY  
ILLINOIS

**FOUR POINTS LAND SURVEYING  
& ENGINEERING, INC.**  
17 NORTHPORT PLAZA  
HANNIBAL, MO. 63401  
573-406-5533  
ILLINOIS PROFESSIONAL DESIGN FIRM #184-006044

|                        |                |                                  |
|------------------------|----------------|----------------------------------|
| BOUNDARY SURVEY        |                | WEISENBORN FARM<br>PREPARED FOR: |
| DRAWN<br>PWS           | CHECKED<br>NDI |                                  |
| DRAWING NAME<br>230101 |                |                                  |
| PROJECT NO.<br>23-0101 |                |                                  |
| SHEET NO.              |                |                                  |

5/3-406-5533  
ILLINOIS PROFESSIONAL DESIGN FIRM #184-006044



A TRACT BEING PART OF THE NORTHWEST AND NORTHEAST QUARTERS OF  
SECTION 19, TOWNSHIP 1 SOUTH, RANGE 8 WEST OF THE  
FOURTH PRINCIPAL MERIDIAN, ADAMS COUNTY, ILLINOIS



NORMAN D. ELLERBROCK  
ILLINOIS PROFESSIONAL LAND SURVEYOR #35-3159  
LICENSE EXPIRES NOVEMBER 30, 2024  
ILLINOIS PROFESSIONAL DESIGN FIRM #184-006044

|                        |                |   |
|------------------------|----------------|---|
| DRAWN<br>WS            | CHECKED<br>NDB | PREPARED FOR:<br><b>WEISENBORN FARM</b> |
|                        |                |   |
| DRAWING NAME:<br>30101 |                | PROJECT NO.:<br>3-0101                  |
| SHEET NO.<br>1 OF 1    |                |   |

ILLINOIS PROFESSIONAL DESIGN FIRM #184-006044  
312-408-3333

KEC