

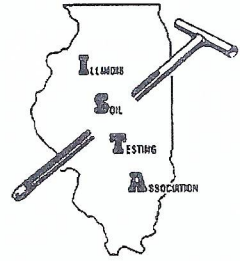

KSI LABORATORIES

202 S. DACEY DR., SHELBYVILLE, ILLINOIS 62565
PHONE (217) 774-2421
www.KSILab.com



Operator: Mark VanEtten
Field: LAW FARM
Acres: 111

Field ID: 129746
Date: 11/21/2019
Submitted By: SUNRISE FS (KILBOURNE)

Legend Base Map

- Water
- Roads
- Timber
- Waterway
- Buildings

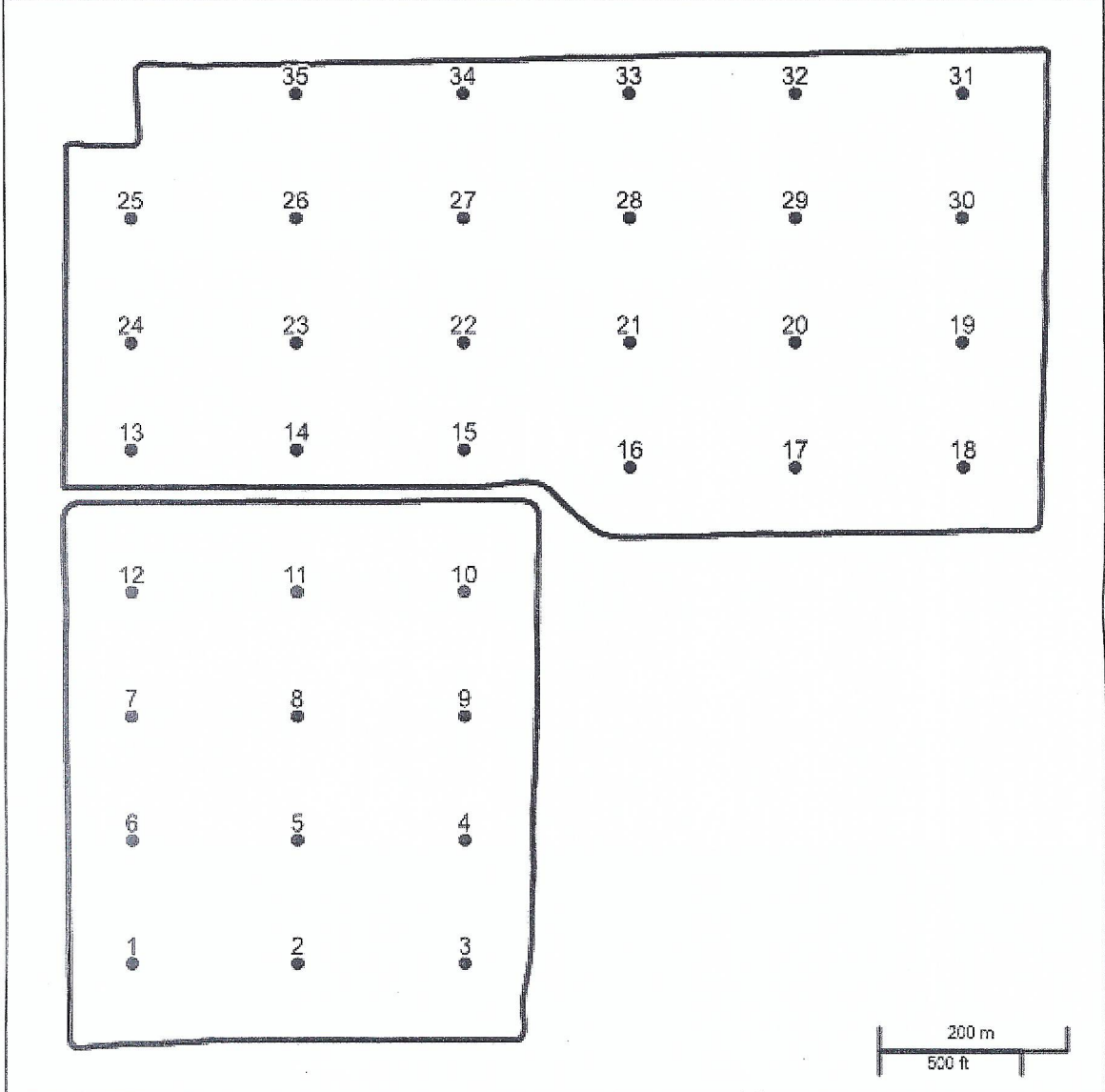

Latitude: 40.185633
Longitude: -89.852438
Grid Size: 330nsx440ew

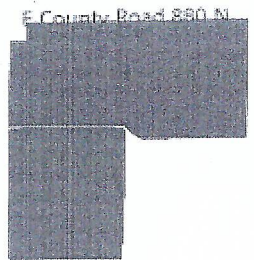

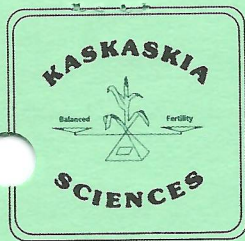

KSI LABORATORIES

202 S. DACEY
SHELBYVILLE, ILLINOIS 62565
PHONE (217) 774-2421



OPERATOR: MARK VANETTEN
FIELD: LAW FARM
ACRES: 111

LAB#: 269460-94 (23797)
DATE: 11/18/2019
SUBMITTED BY: SUNRISE FS (KILBOURNE)

SOIL TEST RESULTS

SAMPLE#	SOIL pH	BUFFER pH	PHOSPHORUS lbs/A	POTASSIUM lbs/A	CALCIUM lbs/A	MAGNESIUM lbs/A	ORGANIC MATTER %	CATION EXCHANGE CAPACITY	BASE SATURATION			
									%Ca	%Mg	%K	%H
1	5.7	6.5	58	258	1301	128	1.6	5.6	58.1	9.6	6.0	26.3
2	6.0	6.9	59	204	1021	196	1.2	4.5	56.8	18.2	5.9	19.2
3	6.3	7.0	43	387	2960	373	2.4	11.0	67.3	14.2	4.6	13.9
4	6.3	7.0	54	262	2742	339	2.3	10.0	68.6	14.2	3.4	13.8
5	6.4	7.0	24	177	1729	296	1.8	6.6	65.5	18.7	3.5	12.2
6	6.1	7.0	30	244	1387	175	1.4	5.5	63.1	13.3	5.7	17.9
7	6.5	7.0	21	187	2311	364	2.1	8.4	68.8	18.1	2.9	10.2
8	6.3	7.0	39	179	1309	214	1.6	5.1	64.2	17.5	4.5	13.7
9	6.4	7.0	25	182	1422	245	1.5	5.5	64.7	18.6	4.3	12.4
10	6.4	7.0	42	185	1373	228	1.5	5.2	66.1	18.3	4.6	11.0
11	6.3	7.0	56	203	1555	239	1.7	6.0	64.8	16.6	4.4	14.1
12	6.5	7.0	20	207	1804	318	1.7	6.8	66.4	19.5	4.0	10.1
13	6.4	7.0	64	261	2115	300	1.9	7.8	67.8	16.1	4.3	11.7
14	6.5	7.0	77	398	2680	376	2.0	9.8	68.4	16.0	5.3	10.3
15	6.5	7.0	66	276	1313	217	1.4	5.0	65.7	18.1	7.1	9.0
16	6.4	7.0	115	299	1668	249	1.6	6.4	65.2	16.3	6.0	12.5
17	6.4	7.0	88	410	2587	358	2.0	9.6	67.4	15.6	5.5	11.5
18	6.4	7.0	114	533	2539	349	2.1	9.6	66.2	15.2	7.2	11.5
19	6.2	6.9	23	180	1924	333	1.8	7.7	62.5	18.1	3.0	16.4
20	6.6	7.0	32	196	1527	272	1.6	5.7	67.0	19.9	4.5	8.6
21	6.4	7.0	15	205	2570	383	2.0	9.4	68.4	17.0	2.8	11.7
22	6.4	7.0	18	224	2266	318	2.1	8.3	68.3	16.0	3.5	12.2
23	6.2	7.0	19	194	2051	309	2.0	7.9	65.0	16.3	3.2	15.5
24	6.4	7.0	152	293	1590	221	1.8	6.0	66.3	15.4	6.3	12.0
25	6.5	7.0	89	356	1578	191	1.5	5.8	68.1	13.8	7.9	10.2
26	6.2	7.0	166	700	3812	425	2.7	14.5	65.8	12.3	6.2	15.7
27	6.3	7.0	53	272	2272	319	2.0	8.6	66.1	15.5	4.1	14.3
28	6.4	7.0	58	223	1461	253	1.5	5.7	64.1	18.5	5.1	12.3
29	6.4	7.0	32	184	1520	247	1.7	5.8	65.6	17.8	4.1	12.5
30	5.6	6.5	30	199	1339	180	1.6	6.0	55.8	12.6	4.3	27.3
31	5.6	6.4	110	297	1311	99	1.6	5.7	57.6	7.3	6.7	28.4
32	6.0	6.8	36	210	1334	209	1.5	5.6	59.6	15.6	4.9	19.9
33	6.3	7.0	32	236	1679	260	1.7	6.5	64.6	16.7	4.7	14.0
34	6.2	7.0	44	262	2324	321	2.0	8.9	65.3	15.1	3.8	15.8
35	6.0	6.9	52	204	1654	245	1.7	6.8	60.9	15.1	3.9	20.2
AVERAGE	6.3	6.9	56	265	1887	273	1.8	7.2	64.7	15.9	4.8	14.5
N AVE.	6.3	EXTRACTED SAMPLES: 1,30,31,										
P1 AVE.	40	EXTRACTED SAMPLES: 16,17,18,24,25,26,31,										
K AVE.	229	EXTRACTED SAMPLES: 3,14,17,18,26,										

ANALYTICAL SERVICES FOR AGRICULTURE