

**TRACT 1 DESCRIPTION - 50.818 ACRES±**

A part of the West Half of the Northwest Quarter of Section 4, Township 5 North, Range 2 East of the Fourth Principal Meridian, Fulton County, Illinois, more particularly described as follows:

Commencing at an iron rod set at the northwest corner of said Section 4; thence South 89 degrees 59 minutes 58 seconds East (Bearings refer to the Illinois Coordinate System, West Zone, NAD 1983), a distance of 209.50 feet along the north line of said Northwest Quarter of Section 4 to the Point of Beginning of the tract to be described:

From said Point of Beginning; thence South 89 degrees 59 minutes 58 seconds East, a distance of 1,107.35 feet along said north line to an iron rod set at the northeast corner of said West Half of the Northwest Quarter of Section 4; thence South 01 degrees 30 minutes 55 seconds West, a distance of 2,722.97 feet along the east line of said West Half of the Northwest Quarter of Section 4; thence along an existing fence for the following courses bearing South 87 degrees 37 minutes 46 seconds West, a distance of 237.05 feet to an iron rod set; thence North 88 degrees 52 minutes 26 seconds West, a distance of 384.29 feet to an iron rod set; thence North 01 degrees 13 minutes 24 seconds East, a distance of 1,693.25 feet to an iron rod set; thence North 87 degrees 39 minutes 04 seconds West, a distance of 508.24 feet to an iron rod set; thence North 03 degrees 14 minutes 59 seconds East, a distance of 1,012.22 feet to the point of beginning, containing 50.818 acres more or less.

Subject to all easements of record and to the rights, if any, of the public for Round Barn Road along the north and east sides of the above described tract.

**TRACT 2 DESCRIPTION AS SURVEYED - 36.239 ACRES±**

A part of the East Half of the Northwest Quarter of Section 4, Township 5 North, Range 2 East of the Fourth Principal Meridian, Fulton County, Illinois, more particularly described as follows:

Beginning at an iron rod set at the northeast corner of said Northwest Quarter of Section 4; thence South 01 degrees 19 minutes 55 seconds West (Bearings refer to the Illinois Coordinate System, West Zone, NAD 1983), a distance of 1,194.07 feet along the east line of said Northwest Quarter of Section 4 to the northeast corner of a strip of land off of the south side of the northeast quarter of the northwest quarter of section 4, containing 4 and 1/2 acres more or less as called for in the senior deed recorded as Document No. 56805 and dated 10/13/1872; thence South 89 degrees 43 minutes 11 seconds West, a distance of 1,320.89 feet to the northwest corner of said strip of land; thence North 01 degrees 31 minutes 00 seconds East, a distance of 1,200.64 feet along the west line of said East Half of the Northwest Quarter of Section 4 to an iron rod set at the northwest corner of said East Half of the Northwest Quarter of Section 4; thence South 89 degrees 59 minutes 58 seconds East, a distance of 1,316.85 feet to the point of beginning, containing 36.239 acres more or less.

Subject to all easements of record and to the rights, if any, of the public for Round Barn Road along the west side of the above described tract.

**TRACT 3 DESCRIPTION - 35.477 ACRES±**

A part of the Southwest Quarter of Section 4, Township 5 North, Range 2 East of the Fourth Principal Meridian, Fulton County, Illinois, more particularly described as follows:

Beginning at an iron rod set at the northeast corner of said Southwest Quarter of Section 4; thence South 01 degrees 19 minutes 55 seconds West (Bearings refer to the Illinois Coordinate System, West Zone, NAD 1983), a distance of 1,284.56 feet along the east line of said Southwest Quarter of Section 4; thence North 88 degrees 40 minutes 05 seconds West, a distance of 18.90 feet to an iron rod set; thence South 58 degrees 19 minutes 13 seconds West, a distance of 110.18 feet to an iron rod set; thence South 38 degrees 10 minutes 53 seconds West, a distance of 22.34 feet to an iron rod set; thence South 08 degrees 49 minutes 50 seconds West, a distance of 114.63 feet to an iron rod set in an existing fence line; thence South 85 degrees 57 minutes 48 seconds West, a distance of 187.91 feet along said existing fence line to an iron rod set; thence North 83 degrees 30 minutes 49 seconds West, a distance of 107.04 feet to an iron rod set; thence South 45 degrees 10 minutes 11 seconds West, a distance of 53.98 feet to an iron rod set; thence South 14 degrees 20 minutes 05 seconds West, a distance of 137.18 feet to an iron rod set in said existing fence line; thence North 86 degrees 56 minutes 46 seconds West, a distance of 232.53 feet along said existing fence line; thence along said existing fence line for the next 5 courses bearing North 00 degrees 54 minutes 31 seconds East, a distance of 358.45 feet to an iron rod set; thence North 11 degrees 40 minutes 53 seconds East, a distance of 343.38 feet to an iron rod set; thence North 49 degrees 07 minutes 05 seconds West, a distance of 20.29 feet to an iron rod set; thence North 78 degrees 31 minutes 07 seconds West, a distance of 331.84 feet to an iron rod set; thence North 06 degrees 41 minutes 38 seconds East, a distance of 796.02 feet to the north line of said Southwest Quarter of Section 4; thence leaving said existing fence line and along said north line bearing North 89 degrees 28 minutes 59 seconds East, a distance of 1,099.99 feet to the point of beginning, containing 35.477 acres more or less.

Subject to all easements of record and to the rights, if any, of the public for Round Barn Road along the north and east sides of the above described tract.

**TRACT 4 DESCRIPTION - 157.381 ACRES±**

A part of the West Half of the Northwest Quarter of Section 4 and a part of the Southwest Quarter of Section 4, Township 5 North, Range 2 East of the Fourth Principal Meridian, Fulton County, Illinois, more particularly described as follows:

Beginning at an iron rod set at the northwest corner of said Section 4; thence South 01 degrees 41 minutes 49 seconds West (Bearings refer to the Illinois Coordinate System, West Zone, NAD 1983), a distance of 2,747.74 feet to an iron rod set at the west quarter corner of said Section 4; thence South 00 degrees 50 minutes 02 seconds West, a distance of 2,655.26 feet to an iron rod found at the southeast corner of said Section 4; thence North 89 degrees 13 minutes 57 seconds East, a distance of 2,629.18 feet to an iron rod set at the southeast corner of said Southwest Quarter of Section 4; thence North 01 degrees 19 minutes 55 seconds East, a distance of 1,359.83 feet along the east line of said Southwest Quarter of Section 4; thence North 88 degrees 40 minutes 05 seconds West, a distance of 18.90 feet to an iron rod set; thence South 58 degrees 19 minutes 13 seconds West, a distance of 110.18 feet to an iron rod set; thence South 38 degrees 10 minutes 53 seconds West, a distance of 22.34 feet to an iron rod set; thence South 08 degrees 49 minutes 50 seconds West, a distance of 114.63 feet to an iron rod set in an existing fence line; thence South 85 degrees 57 minutes 48 seconds West, a distance of 187.91 feet along said existing fence line to an iron rod set; thence North 83 degrees 30 minutes 49 seconds West, a distance of 107.04 feet to an iron rod set; thence South 45 degrees 10 minutes 11 seconds West, a distance of 53.98 feet to an iron rod set; thence South 14 degrees 20 minutes 05 seconds West, a distance of 137.18 feet to an iron rod set in said existing fence line; thence North 86 degrees 56 minutes 46 seconds West, a distance of 232.53 feet along said existing fence line; thence along said existing fence line for the next 5 courses bearing North 00 degrees 54 minutes 31 seconds East, a distance of 358.45 feet to an iron rod set; thence North 11 degrees 40 minutes 53 seconds East, a distance of 343.38 feet to an iron rod set; thence North 49 degrees 07 minutes 05 seconds West, a distance of 20.29 feet to an iron rod set; thence North 78 degrees 31 minutes 07 seconds West, a distance of 331.84 feet to an iron rod set; thence North 06 degrees 41 minutes 38 seconds East, a distance of 796.02 feet to the north line of said Southwest Quarter of Section 4; thence leaving said existing fence line and along said north line bearing North 89 degrees 28 minutes 59 seconds East, a distance of 1,099.99 feet to the point of beginning, containing 157.381 acres more or less.

Subject to all easements of record and to the rights, if any, of the public for Round Barn Road along the north side of the above described tract.

- LEGEND**
- 5/8" IRON ROD FOUND
  - 5/8"x30" IRON ROD WITH PLASTIC CAP STAMPED CLONINGER PLS 2524 SET
  - ☒ CONCRETE RIGHT OF WAY MARKER FOUND
  - SURVEY BOUNDARY LINE
  - - - ALIQUOT SECTION LINE
  - DEED LINE
  - ▲ WOOD OF STEEL POST
  - × × × × × EXISTING FENCE
  - RECORD BEARING AND/OR DISTANCE OR AREA
  - OWNERSHIP TIE

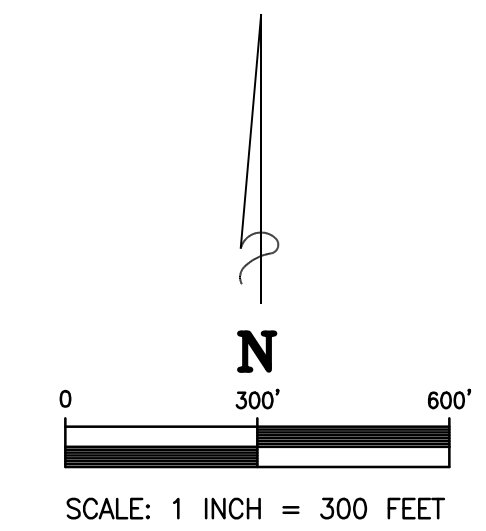

BEARINGS REFER TO THE ILLINOIS COORDINATE SYSTEM, WEST ZONE, NAD 1983, AND ARE BASED ON GNSS OBSERVATIONS.

FIELD WORK COMPLETED 10/09/2024

STATE OF ILLINOIS )  
 COUNTY OF FULTON ) SS

I, Ronald E. Cloninger, Illinois Professional Land Surveyor Number 2524, do hereby certify that I have surveyed a part of the Northwest and Southwest Quarters of Section 4, Township 5 North, Range 2 East of the Fourth Principal Meridian, Fulton County, Illinois and that the attached plot is a true and correct representation of said survey and is an opinion based on a comparison of available information and the physical location of evidence.

Dated this 10th day of October, 2024.

Ronald E. Cloninger  
 Illinois Professional Land Surveyor #2524  
 License Expires 11/30/2026



THIS PROFESSIONAL SERVICE CONFORMS TO THE CURRENT ILLINOIS MINIMUM STANDARDS OF PRACTICE APPLICABLE TO BOUNDARY SURVEYS.

**CLONINGER LAND SURVEYING**  
 27472 EAST COUNTY HWY. 23  
 CANTON, IL 61520  
 CELL PHONE (309) 251-5559  
 PHONE & FAX (309) 647-5559

**BOUNDARY SURVEY PLAT**  
 A PART OF THE NORTHWEST AND SOUTHWEST QUARTERS OF SECTION 4, TOWNSHIP 5 NORTH, RANGE 2 EAST OF THE FOURTH PRINCIPAL MERIDIAN, FULTON COUNTY, ILLINOIS

FOR:	MARY K. WRIGHT ESTATE	
REVISIONS	DATE	PROJECT NO.
	10/10/2024	24039
	REC	DRAWING NO.
	MAC	1
	REC	SHEET 1 OF 1
	CLS19-51	
ILLINOIS PROFESSIONAL DESIGN FIRM NO. 184-005528		